

Quick Installation Guide

450Mbps Wireless N Router

TL-WR945N

Connect the Hardware

If your internet connection is through an Ethernet cable directly from the wall instead of through a DSL / Cable / Satellite modem, connect the Ethernet cable to the router's WAN port, then follow Step 4 and 5 to complete the hardware connection.

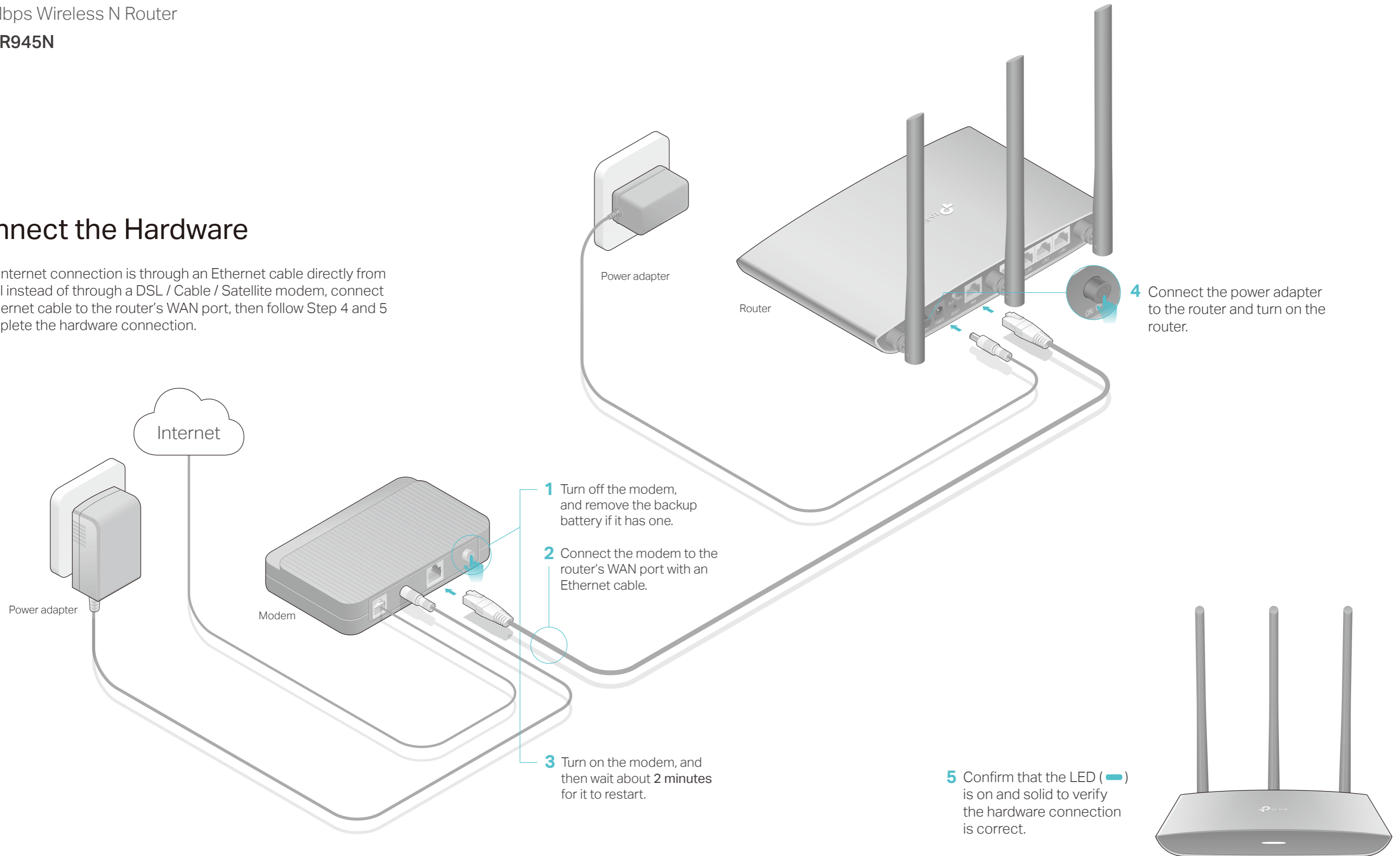

Configure the Router

1. Connecting your computer to the router (Wired or Wireless)

• Wired

Turn off the Wi-Fi on your computer and connect the devices as shown below.

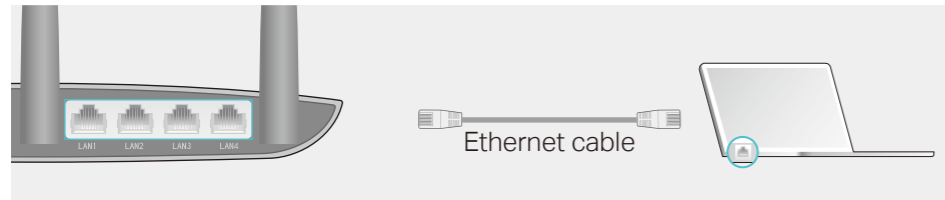

• Wireless

a Find the SSID (Network Name) and Wireless Password printed on the Information Card.



b Click the network icon of your computer or go to Wi-Fi Settings of your smart device, and then select the SSID to join the network.

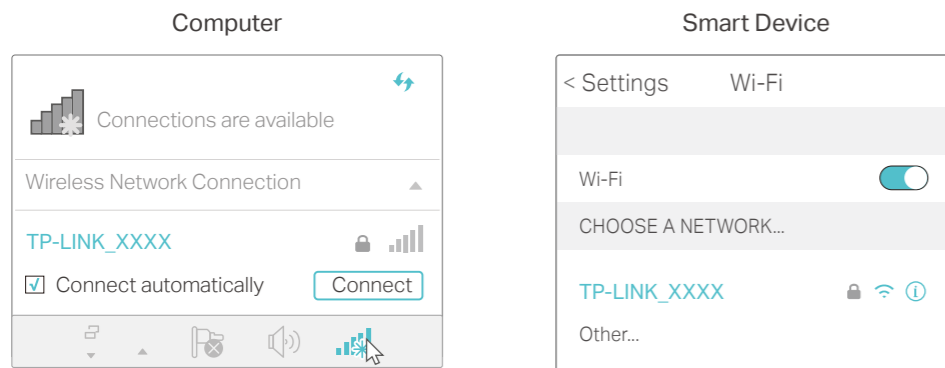

2. Configure the router using a web browser

A Launch a web browser, and enter <http://tplinkwifi.net> or <http://192.168.0.1> in the address bar. Use **admin** for both username and password, and then click **Login**.

Note: If the login window does not appear, please refer to FAQ > Q1.

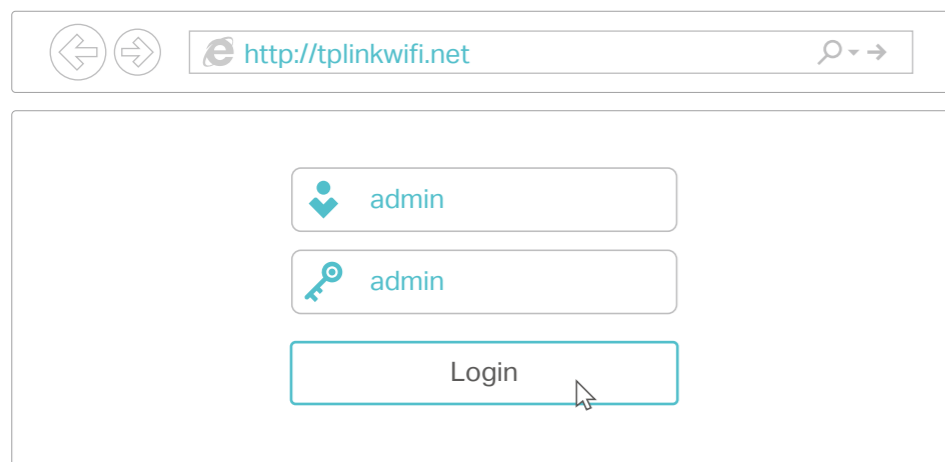

B Follow the step-by-step instructions of the Quick Setup to complete the initial configuration.

Note: If you are not sure of the WAN Connection Type, please click Auto-Detect.

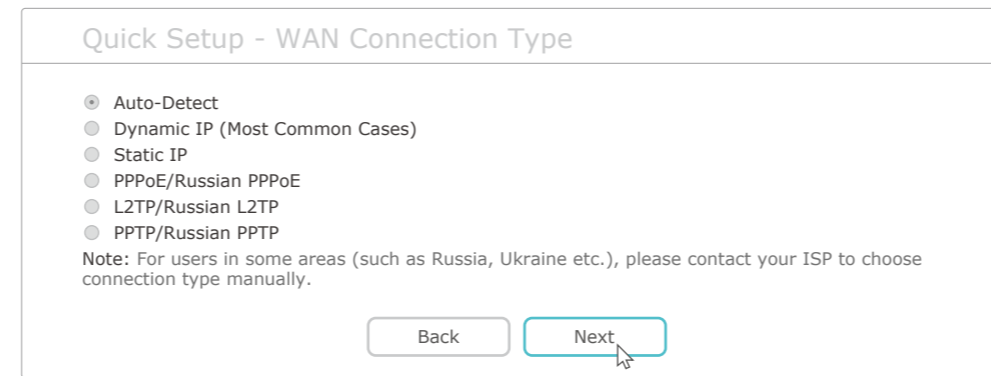

😊 Enjoy the internet!

LED Indicator

LED	Status	Explanation
On (Orange)	On (Orange)	Power is on, but there is no internet connection.
On (Blue)	On (Blue)	The router is connected to the internet.
Blinking slowly	Blinking slowly	The system is starting up or firmware is being upgraded. Do not disconnect or power off your router.
Blinking quickly	Blinking quickly	WPS connection is in progress. This may take up to 2 minutes.

Tether App

The TP-LINK Tether app provides a simple, intuitive way to access and manage your router.

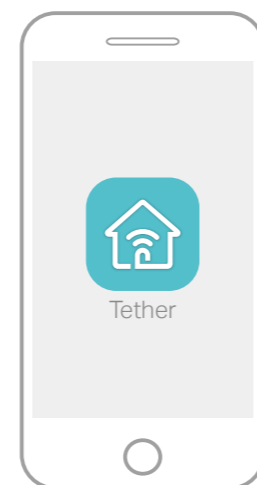

- Block unwelcome users from connecting to your network
- Change the basic wireless network settings
- View information about clients connected to your router
- Set up Parental Controls with access time

How to begin?

1. Download the TP-LINK Tether app from the Apple App Store or Google Play.
2. Ensure your smart device is wirelessly connected to the home network.
3. Launch the Tether app and start managing your home network.



Scan to download

More Features

The TP-LINK router supports various features, such as Guest Network, Parental Controls, Access Control and more. You can log in to the router's web management page <http://tplinkwifi.net> to apply these functions. For instructions, please refer to the **User Manual** at www.tp-link.com.

FAQ (Frequently Asked Questions)

Q1. What can I do if the login window does not appear?

- If the computer is set to a static or fixed IP address, change the setting to obtain an IP address and DNS service address automatically.
- Verify that <http://tplinkwifi.net> is correctly entered in the web browser. Alternatively, enter <http://192.168.0.1> or <http://192.168.1.1> in the web browser and press **Enter**.
- Use another web browser and try again.
- Reboot your router and try again.
- Disable and then enable the network adapter being used.

Q2. What can I do if I cannot access the internet?

- Check if the internet is working normally by connecting a computer directly to the modem using an Ethernet cable. If it is not, contact your internet service provider.
- Log in to the web management page of the router, and go to the **Status** page to check whether the WAN IP address is valid or not. If it is, please run the Quick Setup again; otherwise, recheck the hardware connection.
- Reboot your router and try again.
- For cable modem users, log in to the web management page of the router. Go to **Network > MAC Clone**, click **Clone MAC Address** and click **Save**. Then reboot both the modem and the router.

Q3. How do I restore the router to its factory default settings?

- With the router powered on, use a pin to press and hold the **RESET** button on the back panel of the router until the LED blinks.
- Log in to the web management page of the router. Go to **System Tools > Factory Defaults** and click **Restore**. The router will restore and reboot automatically.

Q4. What can I do if I forgot my web management password?

- Refer to FAQ > Q3 to reset the router, and then use **admin** (all lowercase) for both username and password to log in.

Q5. What can I do if I forgot my wireless network password?

- The factory default wireless password is printed on the Information Card.
- Connect a computer directly to the router using an Ethernet cable. Log in to the router's web management page, and go to **Wireless > Wireless Security** to obtain or reset your wireless password.

If your questions are not listed here, please refer to the support page at www.tp-link.com.