

Quick Start

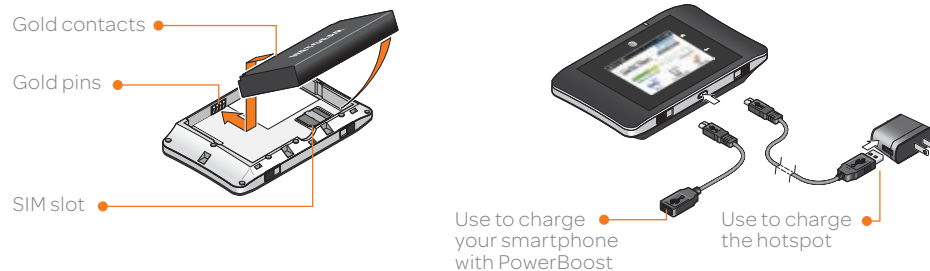

Set Up Your Mobile Hotspot

- ① Insert the pre-charged battery.
- ② Install the back cover.



Note: The mobile hotspot comes with a pre-installed SIM card.

Home Screen

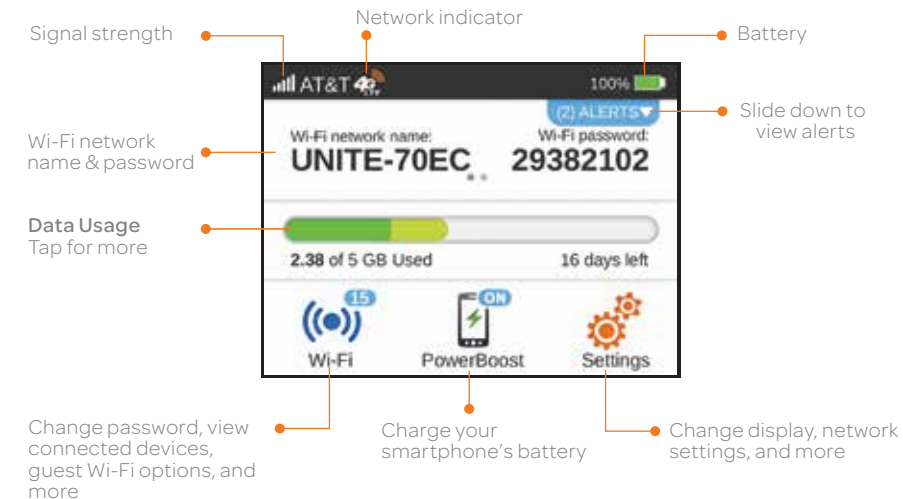

Connect to the Internet

Turn on your Mobile Hotspot

- ① Press and release the power button

Note: The home screen displays the hotspot's Wi-Fi network name and password.

On your laptop or other wireless devices

- ② Open your Wi-Fi/network connection manager.
- ③ Connect your device to the hotspot with the Wi-Fi name and password.

Note: The AT&T Unite Pro home screen goes dark to save power. Press and release the power button to wake the screen.

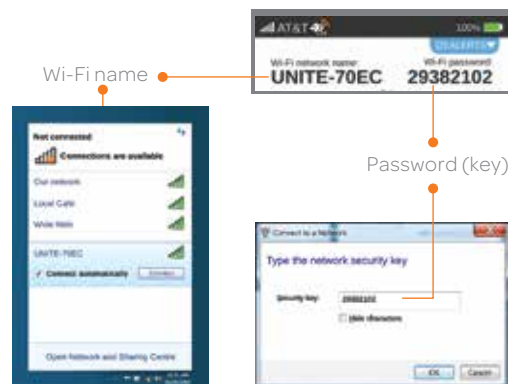

Basic Connection and Device Options

Change Wi-Fi settings



Wi-Fi

- Enable Dual-Band Wi-Fi
- Enable Guest Wi-Fi
- Change Main and Guest Wi-Fi names/password
- View connected devices
- Set maximum number of devices
- Read SMS messages



Change basic device settings



Settings

- Adjust screen timeout
- Adjust data connection settings
- Update software
- Find hotspot's wireless number
- Set Wi-Fi range
- Hide Wi-Fi network name and password



PowerBoost – Battery Backup on the Road

Use your mobile hotspot to charge your smartphone if its battery is low or out of power.

- ① Connect the PowerBoost cable to the mobile hotspot's charging port.
- ② Connect your smartphone's charging cable to the PowerBoost connector.
- ③ On the home screen, tap PowerBoost.
- ④ Select how long to boost (30/60/90 minutes).

Notes:

- To avoid depleting the hotspot's battery, the hotspot stops boosting when its battery reaches 10%. To restart boosting, go to step ③.
- You can't charge the hotspot while it is boosting your smartphone.



Wi-Fi Network Name and Password

Change Wi-Fi network name and password

- ① On the home screen, tap **Wi-Fi > Main Wi-Fi**.
- ② Tap **Edit** beside the name or password to be changed.
- ③ Tap **Continue**.

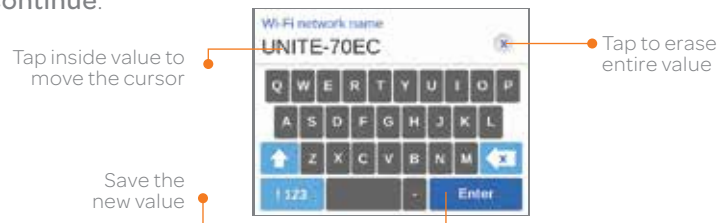

Hide password

To prevent unauthorized users from seeing the password and using the hotspot connection, hide the password on the home screen:

- ① On the home screen, tap **Settings > Display**.
- ② Tap **Wi-Fi Info on Home Screen** and select **Hide**.

Advanced Settings – In your Browser

Access device information and settings via the AT&T Unite Pro Manager page from your connected device.

- ① Connect a Wi-Fi device to your mobile hotspot.
- ② Go to <http://attunitepro> in the connected device's browser.
- ③ Login is **attadmin**.

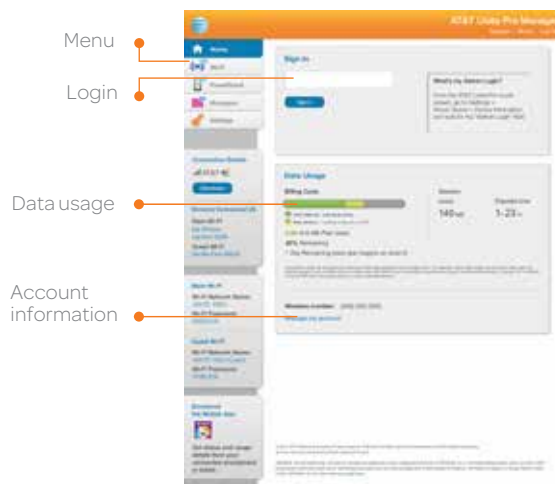

Advanced Connection Options

You can set the AT&T Unite Pro to enable either Dual-Band Wi-Fi or a Guest Wi-Fi network.

Dual-Band Wi-Fi

For faster throughput on compatible devices, use Dual-Band Wi-Fi (this may use more standby power).

- ① On the home screen, tap **Wi-Fi > Dual-Band Wi-Fi**.
- ② Tap **ON**. Connected compatible devices supporting 5GHz Wi-Fi will now have faster throughput.



Guest Wi-Fi

To let guests temporarily share your Wi-Fi without sharing your standard password:

- ① On the home screen, tap **Wi-Fi > Guest Wi-Fi**.
- ② Tap **ON**. Guests can now choose the Guest network in their connection manager.



Advanced Connection Options (continued)

Block device access

To prevent a device from reconnecting to the mobile hotspot, add it to the hotspot's blocked list:

- ① On the home screen, tap **Wi-Fi > Devices**.
- ② Select the device you want to block (there could be more than one page of connected devices).
- ③ Follow the displayed instructions to block the device.



Unblock a device

- ① On the home screen, tap **Wi-Fi > Devices > Blocked List**.
- ② Select the device to unblock, then tap **Unblock**.



Connect WPS devices

Use Wi-Fi Protected Setup (WPS) to connect WPS-enabled devices without entering the Wi-Fi password.

- ① On the home screen, tap **Wi-Fi > WPS** and select a pairing option.
- ② Press the WPS button on a device you want to connect to your mobile hotspot.



Advanced Settings – In your Browser

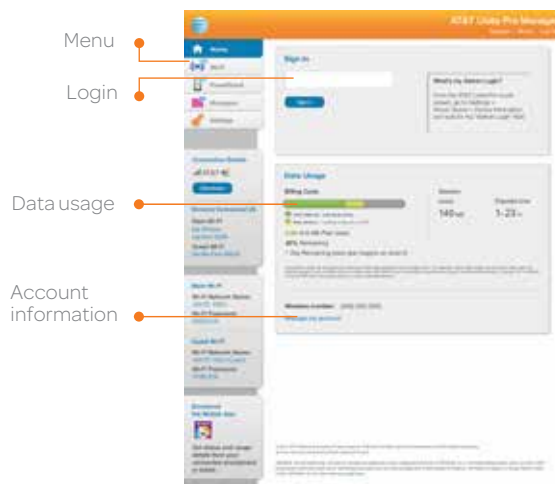

Access device information and settings via the AT&T Unite Pro Manager page from your connected device.

- ① Connect a Wi-Fi device to your mobile hotspot.
- ② Go to <http://attunitepro> in the connected device's browser.
- ③ Login is **attadmin**.



Network Indicators

Your 4G LTE wireless device will display one of the following network indicators to let you know which of AT&T's wireless networks you are connected to.

-  Connected to AT&T's 4G LTE network.
-  Connected to AT&T's HSPA+ network.

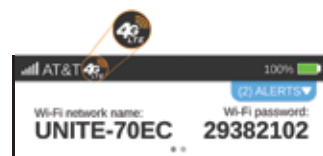

4G LTE not available everywhere. LTE is a trademark of ETSI. Learn more at att.com/network.

A network indicator does not necessarily mean that you will experience any particular upload or download data speeds. Actual upload and download data speeds depend upon a variety of factors, including the device, network utilization, file characteristics, terrain, etc. Learn more at wireless.att.com/learn/articlesresources/wireless-terms.jsp Your AT&T Wireless Customer Agreement, Section 3.2 Where and How Does AT&T Service Work?

Find More Information

On your Mobile Hotspot

- On the home screen, tap **Settings > About Device > Tutorial**.

On the Web

- Visit the interactive web tutorials available at att.com/devicehowto. Select brand: **AT&T**; model: **Unite Pro**.
- Additional support is available online, including device applications, troubleshooting and user forums at att.com/DeviceSupport.

On the phone

- Call AT&T Customer Care at **1-800-331-0500** for assistance with your AT&T service. When prompted, enter the 10-digit wireless phone number associated with your DataConnect service. The wireless phone number is found on the mobile hotspot at **Settings > About Device > Status**.

NETGEAR and the NETGEAR logo are registered trademarks of NETGEAR, Inc. LTE is a trademark of ETSI. © 2013 AT&T Intellectual Property. All rights reserved. AT&T, the AT&T logo and all of the AT&T marks contained herein are trademarks of AT&T Intellectual Property and /or AT&T affiliated companies. All other marks contained herein are the property of their respective owners.