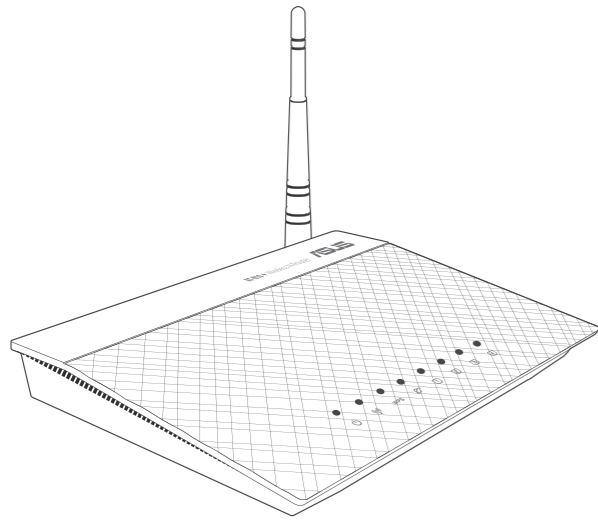
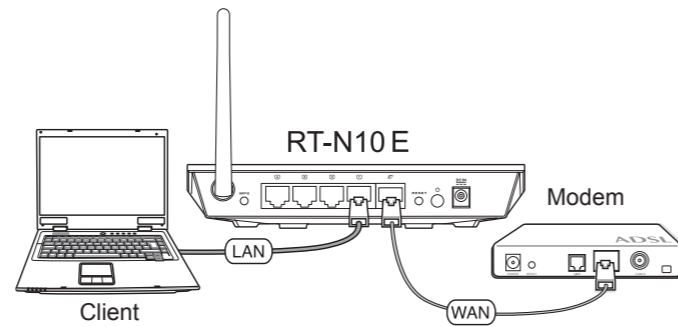
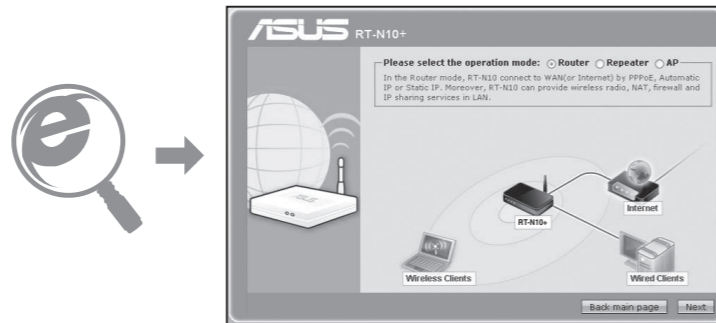
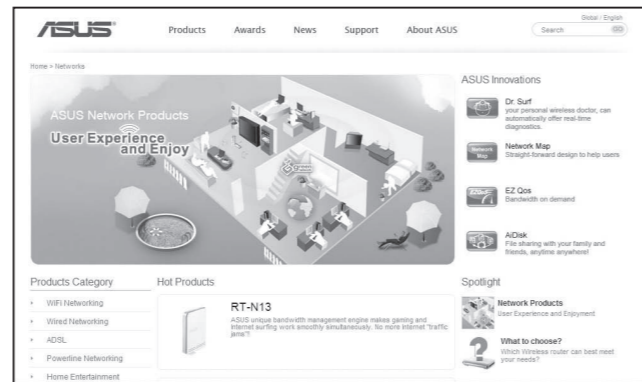

ASUS®**RT-N10 E****ASUS Wireless EZ N Router****Quick Start Guide****1. Connect your devices.****2. Launch the web browser and follow the Quick Internet Setup (QIS) steps.****3. Setup is completed.****Setting up a Home Network****English**

1. Connect your devices.
2. Launch the web browser and follow the Quick Internet Setup (QIS) steps.
* If the QIS web page does not appear after you launched the web browser, disable the proxy settings of the web browser.
3. Setup is completed.

繁體中文

1. 連接裝置。
2. 開啟網頁瀏覽器並按照快速網際網路設定 (QIS) 的步驟操作。
* 當您啟動網頁瀏覽器後，若 QIS 頁面沒有顯示，請嘗試關閉瀏覽器的 Proxy 設定。
3. 設定完成。

简体中文

1. 连接设备。
2. 开启网页浏览器并按照快速互联网设置 (QIS) 的步骤操作。
* 当您启动网页浏览器后，若 QIS 页面没有显示，请尝试关闭浏览器的代理设置。
3. 设置完成。

Français

1. Connectez les périphériques.
2. Lancez votre navigateur Web puis suivez les étapes du gestionnaire de configuration rapide d'Internet en ligne (QIS).
* Si la page Web de QIS ne s'affiche pas lorsque vous lancez le navigateur Internet, désactivez les paramètres proxy du navigateur Internet.
3. La configuration est terminée.

Deutsch

1. Schließen Sie Ihre Geräte an.
2. Starten sie einen Web-Browser und folgen sie den Internet-Schnelleinstellungsschritten (QIS).
* wenn die QIS-Seite nicht erscheint, nachdem Sie den Webbrowser gestartet haben, deaktivieren Sie bitte die Proxy-Einstellungen Ihres Webbrowsers.
3. Die Einrichtung ist fertig.

Italiano

1. Collegare le periferiche.
2. Avviare il browser web e seguire la procedura QIS (Quick Internet Setup).
* Se, dopo aver avviato il browser web, non si riesce a visualizzare la pagina web QIS, disattivare le impostazioni proxy del browser.
3. La configurazione è stata completata.

Русский

1. Подключите ваши устройства.
2. Запустите браузер и следуйте инструкциям быстрого подключения к Интернету (QIS).
* Если страница QIS не появилась после запуска браузера, отключите настройки прокси-сервера в браузере.
3. Установка завершена.

Български

1. Свържете устройствата.
2. Стартирайте уеб браузъра и следвайте стъпките в Quick Internet Setup (QIS) (Бързи интернет настройки).
* Ако уеб сайтът QIS не се появи след като сте стартирали уеб браузъра, деактивирайте настройките на прокси сървъра на уеб браузъра.
3. Конфигурирането приключи.

Česky

1. Připojte zařízení.
2. Spusťte webový prohlížeč a postupujte podle kroků Rychlého nastavení Internetu (QIS).
* Pokud se po spuštění webového prohlížeče nezobrazí webová stránka QIS, deaktivujte nastavení proxy webového prohlížeče.
3. Instalace je dokončena.

Dansk

1. Tilslut enhederne.
2. Start webbrowseren og følg quick-internetopsætning (QIS) trinene.
* Hvis denne QIS side ikke ses efter, at webbrowseren er startet, skal webbrowserens proxyindstillinger deaktiveres.
3. Opsætning fuldført.

Nederlands

1. Sluit uw apparaten aan.
2. Start de webbrowser en volg de QIS-stappen (Quick Internet Setup (snelle internetinstelling)).
* Als de QIS-webpagina niet verschijnt nadat u de webbrowser hebt gestart, moet u de proxy-instellingen van de webbrowser uitschakelen.
3. De instelling is voltooid.

Eesti

1. Ühendage seadmed.
2. Käivitage veebibrauser ja järgige viisardi Quick Internet Setup (Interneti-ühenduse kiirhäälestus (QIS)) samme.
* Kui pärast veebibrauseri käivitamist QIS'i veebileht ei ilmu, siis keelake veebibrauseri puhvisätteid.
3. Häälestus on lõpule viidud.

Suomi

1. Kytke laitteet.
2. Käynnistä verkkoselain ja noudata QIS-asennuksen vaiheita.
* Jos QIS-verkkosivu ei tule näkyviin verkkoselaimen käynnistämisen jälkeen, ota verkkoselaimen proxy-asetus pois päältä.
3. Asennus on valmis.

Ελληνικά

1. Συνδέστε τις συσκευές σας.
2. Εκκινήστε το πρόγραμμα πλοήγησης στο διαδίκτυο και ακολουθήστε τα βήματα της Γρήγορης Εγκατάστασης Internet (QIS).
* Αν η ιστοσελίδα QIS (Γρήγορη Ρύθμιση Internet) δεν εμφανιστεί αφού εκκινήσετε το πρόγραμμα περιήγησης στο διαδίκτυο, απενεργοποιήστε τις ρυθμίσεις του διακομιστή μεσολάβησης από το πρόγραμμα περιήγησης στο διαδίκτυο.
3. Η εγκατάσταση έχει ολοκληρωθεί.

Magyar

1. Csatlakoztassa az eszközöket.
2. Indítsa el a webböngészőt, és kövesse a gyors internetes beállítás (QIS) lépéseit.
* Ha a QIS weblap nem jelenik meg a böngészőprogram indítása után, tiltsa le a böngészőprogram proxy-beállításait.
3. A beállítás befejeződött.

Bahasa Indonesia

1. Sambungkan perangkat.
2. Aktifkan browser Web, kemudian ikuti langkah-langkah Quick Internet Setup (QIS).
* Jika halaman Web QIS tidak muncul di layar setelah Anda mengaktifkan browser Web, nonaktifkan pengaturan proxy browser Web Anda.
3. Konfigurasi selesai.

Latviski

1. Savienojiet savas ierīces.
2. Palaidiet tīmekļa pārlūku un izpildiet Quick Internet Setup (Ātrās interneta palaišanas) (QIS) soļus.
* Ja pēc tīmekļa pārlūka palaišanas QIS tīmekļa lapa neparādās, atspējojiet proxy iestatījumus tīmekļa pārlūka.
3. Iestatīšana ir pabeigta.

Lietuvių

1. Prijunkite prietaisus.
2. Paleiskite interneto naršyklę ir vadovaukitės greitos internetinės sąrankos (QIS) nuorodomis.
* Jei paleidus interneto naršyklę neatsiveria QIS puslapis, dezaktyvuokite interneto naršyklės „Proxy“ nustatymus.
3. Sąranka baigta.

Português do Brasil

1. Conecte seus dispositivos.
2. Lance o navegador da web e siga os passos do Quick Internet Setup (QIS).
* Se a webpage QIS não for exibida, depois de ter lançado o navegador da web, desabilite os ajustes de proxy do mesmo.
3. A instalação foi concluída.

Norsk

- Koble til enhetene dine.
- Start nettleseren og følg trinnene til Quick Internet Setup (QIS) (Rask oppsett av Internett).
 - Hvis QIS-websiden ikke vises etter at du starter nettleseren, deaktiverer du proxy-innstillingene til nettleseren.
- Oppsettet er ferdig.

Portuguese

- Podłącz swoje urządzenia.
- Uruchom przeglądarkę internetową i postępuj zgodnie z poleceniami Szybkiej konfiguracji Internetu (QIS).
 - Jeżeli strona sieciowa QIS nie jest wyświetlana po uruchomieniu przeglądarki sieciowej, należy wyłączyć ustawienia proxy przeglądarki sieciowej.
- Konfiguracja została zakończona.

Português

- Ligue os dispositivos.
- Abra o browser da web e siga as instruções para configuração rápida da Internet.
 - Se a página Web da função QIS não for exibida ao iniciar o navegador Web, desactive as definições de proxy do navegador Web.
- A configuração fica assim concluída.

Română

- Conectați dispozitivele dvs.
- Lansați browser-ul web și urmați pașii de Conectare Rapidă la Internet (QIS).
 - Dacă pagina web QIS nu apare după ce ați lansat browserul web, dezactivați setările proxy ale browserului web.
- Conectarea este finalizată.

Slovensky

- Pripojte svoje zariadenia.
- Spustite internetový prehliadač a postupujte podľa krokov Stručného návodu pre nastavenie internetu (QIS).
 - Pokiaľ sa webová stránka QIS nezobrazí po spustení internetového prehliadača, deaktivujte proxy nastavenia internetového prehliadača.
- Nastavenie je dokončené.

Svenska

- Connecte sus dispositivos.
- Abra su explorador web y siga los pasos indicados por la función Quick Internet Setup rápida de Internet.
 - Si la página web de QIS no aparece tras abrir el explorador web, deshabilite la configuración proxy del explorador web.
- Ha finalizado la configuración.

ไทย

- เชื่อมต่ออุปกรณ์ของคุณ
- เปิดเว็บเบราว์เซอร์ และทำตามขั้นตอน การตั้งค่าอินเทอร์เน็ตด่วน (QIS)
 - ถ้าเว็บเพจ QIS ไม่ปรากฏขึ้นหลังจากที่คุณเปิดเว็บเบราว์เซอร์ ให้ปิดการตั้งค่าการตั้งค่า proxy ของเว็บเบราว์เซอร์
- การตั้งค่าเสร็จสมบูรณ์

Türkçe

- Aygıtlarınızı bağlayın.
- Web tarayıcınızı açın ve Quick Internet Setup (Hızlı İnternet Kurulumu) (QIS) adımlarını izleyin.
 - QIS web sayfası, web tarayıcınız başlatıldıktan sonra ekrana gelmiyorsa, web tarayıcınızın proxy ayarlarını devre dışı bırakın.
- Kurulum tamamlanır.

Українська

- Підключіть пристрої.
- Запустіть браузер і дотримуйтеся інструкцій для Швидкого з'єднання з мережею Інтернет (QIS).
 - Якщо веб-сторінка QIS не з'являється після того, як Ви запустили веб-браузер, вимкніть налаштування проху веб-браузера.
- Налаштування завершено.

IMPORTANT NOTE:
IC Radiation Exposure Statement:
This equipment complies with IC RSS-102 radiation exposure limits set forth for an uncontrolled environment.
This equipment should be installed and operated with minimum distance 20cm between the radiator & your body.
Declaración de exposición a la radiación de Canada:
Este equipo cumple con los límites de exposición a la radiación de la IC establecidos para un ambiente no controlado.
Este equipo se debe instalar y operar con una distancia mínima de 20 cm entre el radiador y su cuerpo.

Federal Communications Commission Statement

This device complies with Part 15 of the FCC Rules. Operation is subject to the following two conditions:

- This device may not cause harmful interference.
- This device must accept any interference received, including interference that may cause undesired operation.

This equipment has been tested and found to comply with the limits for a class B digital device, pursuant to part 15 of the FCC Rules. These limits are designed to provide reasonable protection against harmful interference in a residential installation.

This equipment generates, uses and can radiate radio frequency energy and, if not installed and used in accordance with the instructions, may cause harmful interference to radio communications. However, there is no guarantee that interference will not occur in a particular installation. If this equipment does cause harmful interference to radio or television reception, which can be determined by turning the equipment off and on, the user is encouraged to try to correct the interference by one or more of the following measures:

- Reorient or relocate the receiving antenna.
- Increase the separation between the equipment and receiver.
- Connect the equipment into an outlet on a circuit different from that to which the receiver is connected.
- Consult the dealer or an experienced radio/TV technician for help.

	CAUTION: Any changes or modifications not expressly approved by the party responsible for compliance could void the user's authority to operate the equipment.
---	---

Prohibition of Co-location

This device and its antenna(s) must not be co-located or operating in conjunction with any other antenna or transmitter.

Safety Information

To maintain compliance with FCC's RF exposure guidelines, this equipment should be installed and operated with minimum distance 20cm between the radiator and your body. Use on the supplied antenna.

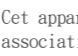
	CAUTION: Do not touch the antenna when the device is powered on. The antenna can become hot during operation.
--	--

Declaration of Conformity for R&TTE directive 1999/5/EC

Essential requirements – Article 3

Protection requirements for health and safety – Article 3.1a

Testing for electric safety according to EN 60950-1 has been conducted. These are considered relevant and sufficient.

Protection requirements for electromagnetic compatibility – Article 3.1b

Testing for electromagnetic compatibility according to EN 301 489-1 and EN 301 489-17 has been conducted. These are considered relevant and sufficient.

Effective use of the radio spectrum – Article 3.2

Testing for radio test suites according to EN 300 328- 2 has been conducted. These are considered relevant and sufficient.

CE Mark Warning

This is a Class B product, in a domestic environment, this product may cause radio interference, in which case the user may be required to take adequate measures.

Operation Channels: Ch1~11 for N. America, Ch1~14 Japan, Ch1~13 Europe (ETSI)

NCC Warning

經型式認證合格之低功率射頻電機，非經許可，公司、商號或使用者均不得擅自變更頻率、加大功率或變更原設計之特性及功能。

低功率射頻電機之使用不得影響飛航安全及干擾合法通信；經發現有干擾現象時，應立即停用，並改善至無干擾時方得繼續使用。

前項合法通信，指依電信法規定作業之無線電通信。

低功率射頻電機須忍受合法通信或工業、科學及醫療用電波輻射性電機設備之干擾。

REACH

Complying with the REACH (Registration, Evaluation, Authorisation, and Restriction of Chemicals) regulatory framework, we published the chemical substances in our products at ASUS REACH website at <http://csr.asus.com/english/REACH.htm>.

	电子信息产品污染控制标示：图中之数字为产品之环保使用期限。仅指电子信息产品中含有的有毒有害物质或元素不致发生外泄或突变从而对环境造成污染或对人身、财产造成严重损害的期限。
---	---

部件名称	有害物质或元素					
	铅 (Pb)	汞 (Hg)	镉 (Cd)	六价铬 (Cr(VI))	多溴联苯 (PBB)	多溴二苯醚 (PBDE)
印刷电路板及其电子组件	×	○	○	○	○	○
外壳	×	○	○	○	○	○
电源适配器	×	○	○	○	○	○
外部信号连接器及线材	×	○	○	○	○	○
中央处理器与内存	×	○	○	○	○	○

○：表示该有毒有害物质在该部件所有均质材料中的含量均在 SJ/T 11363-2006 标准规定的限量要求以下。

×：表示该有毒有害物质至少在该部件的某一均质材料中的含量超出 SJ/T 11363-2006 标准规定的限量要求，然该部件仍符合欧盟指令 2002/95/EC 的规范。

备注：此产品所标示之环保使用期限，系指在一般正常使用状况下。

Hot Products

RT-N55U

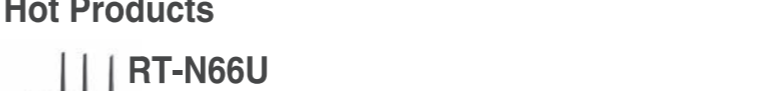

- 2.4 GHz and 5 GHz Concurrent Dual-Band Transmissions for Strong Signal Strength and Ultra-Fast Connection Rates up to 900Mbps
- Gigabit Ethernet Ports for the Fastest, Most Reliable Internet Performance
- Download Master for Wireless Data Storage and Access to Router-Connected USB Storage Devices
- Expanded Wireless Coverage with Detachable High-Powered Antennas
- File Sharing, Printer Sharing, and 3G Sharing via Two Multi-Functional Built-in USB Ports
- ASUSWRT Dashboard UI for Easy Setup, Signal Monitoring, and Network Application Control

RT-N66U



- Powerful Dual-band 3x3 Ethernet Adapter Delivers Extreme 450Mbps Wi-Fi Speed
- Selectable 2.4GHz/ 5GHz Dual-band Reduces Wi-Fi Interference for HD Multimedia
- Patent Orthogonal Antenna Design for Best Wi-Fi Coverage
- 3-in-1 Function: Ethernet Adapter, Universal Repeater, and AP Mode
- Quick and Easy Setup with ASUS New UI

RT-N56U

- Concurrent Dual Band - Two 300Mbps Wireless-N networks at one time
- Guest Network Access - Four separated wireless networks on the 2.4GHz band with customized security and access restrictions
- Easy Universal Repeater - Extend your Parent AP in the fastest and most intuitive way.
- Clever Wall-mount Design
- Parental Control - Control your kids' computer time

RT-N53



- Concurrent Dual Band - Two 300Mbps Wireless-N networks at one time
- Guest Network Access - Four separated wireless networks on the 2.4GHz band with customized security and access restrictions
- Easy Universal Repeater - Extend your Parent AP in the fastest and most intuitive way.
- Clever Wall-mount Design
- Parental Control - Control your kids' computer time

- Dual-band for lag-free entertainment
- Gigabit Ethernet Ports for the Fastest, Most Reliable Internet Performance

- 5X faster gigabit internet surfing with hardware NAT
- File Sharing, Printer Sharing, and 3G Sharing via Two Multi-Functional Built-in USB Ports
- Powerful Online Multitasking at up to 300,000 Data Sessions

RT-N66U



- 2.4 GHz and 5 GHz Concurrent Dual-Band Transmissions for Strong Signal Strength and Ultra-Fast Connection Rates up to 900Mbps
- Gigabit Ethernet Ports for the Fastest, Most Reliable Internet Performance
- Download Master for Wireless Data Storage and Access to Router-Connected USB Storage Devices
- Expanded Wireless Coverage with Detachable High-Powered Antennas
- File Sharing, Printer Sharing, and 3G Sharing via Two Multi-Functional Built-in USB Ports
- ASUSWRT Dashboard UI for Easy Setup, Signal Monitoring, and Network Application Control

RT-N53



- Concurrent Dual Band - Two 300Mbps Wireless-N networks at one time
- Guest Network Access - Four separated wireless networks on the 2.4GHz band with customized security and access restrictions
- Easy Universal Repeater - Extend your Parent AP in the fastest and most intuitive way.
- Clever Wall-mount Design
- Parental Control - Control your kids' computer time

RT-N55U



- 2.4 GHz and 5 GHz Concurrent Dual-Band Transmissions for Strong Signal Strength and Ultra-Fast Connection Rates up to 900Mbps
- Gigabit Ethernet Ports for the Fastest, Most Reliable Internet Performance
- Download Master for Wireless Data Storage and Access to Router-Connected USB Storage Devices
- Expanded Wireless Coverage with Detachable High-Powered Antennas
- File Sharing, Printer Sharing, and 3G Sharing via Two Multi-Functional Built-in USB Ports
- ASUSWRT Dashboard UI for Easy Setup, Signal Monitoring, and Network Application Control

RT-N66U



- Powerful Dual-band 3x3 Ethernet Adapter Delivers Extreme 450Mbps Wi-Fi Speed
- Selectable 2.4GHz/ 5GHz Dual-band Reduces Wi-Fi Interference for HD Multimedia
- Patent Orthogonal Antenna Design for Best Wi-Fi Coverage
- 3-in-1 Function: Ethernet Adapter, Universal Repeater, and AP Mode
- Quick and Easy Setup with ASUS New UI