

W906 User Manual



Wireless AP Easy

1.Package contents

- One W906 Portable Wireless AP
- One User Manual
- Optional Power Adaptor

2.LED Indicator and Port Description

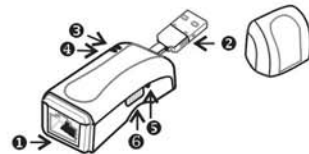

Figure 1

1	10/100M RJ45 port
2	USB port
3	Power LED indicator
4	Status LED indicator
5	Reset button
6	Mode Switch

3. Working mode introduction

3-1. Wireless AP mode

Push the working mode switch button to the AP side, the device worked as a converter between the wired and wireless signal.

3-1-1. Application and Network Topology

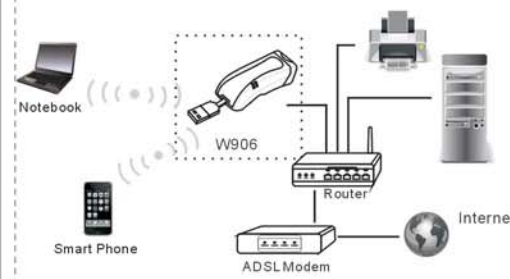

Figure 3-1-1 Topology of W906 AP mode

3-1-2 Hardware installation



Figure 3-1-2 Hardware installation of AP Mode

A) Connect one end of Ethernet cable to broadband router or switch, and the other end to the W906's LAN port

B) Insert A-Type USB plug to a 5V DC power adapter or pc USB Port. The power LED on the panel will light on as soon as the AP's powers on.

4.Quick Connection Guide(AP Mode)

4-1 Windows 7

4-1-1. Refresh wireless network list and then select the SSID to connect (the default SSID is Mini WiFi AP-XXX)



Figure 4-1-1 Select SSID to connect

4-1-2.Input password (default: 88888), click "OK".



Figure 4-2 Input password

4-1-3. successful connected

Figure 4-1-3 Successful connected to W906

4-2. iPhone

4-2-1. Setting --> WiFi --(turn on WiFi)--> Choose Mini WiFi AP-XXX



Figure 4-2-1 Select SSID to connect

4-2-2. Input password (default: 88888)



Figure 4-2-2 Input password

4-2-3. successful connected



Figure 4-2-3 Successful connected

5. Configure and Manage AP

With a web browser such as Microsoft Internet Explorer and Mozilla Firefox, it is easy to configure and manage the W906 wireless AP.

5-1. Launch a web browser such as Internet Explorer, enter the default IP Address: [HTTP://192.168.1.225](http://192.168.1.225), press "Enter".



Note:
Except for the fixed SSID prefix "Mini WiFi AP-", here you must input 3 characters to avoid "connection fail" problem!

Figure 5-1 Wireless AP Settings Page

- >SSID: SSID(Service Set Identifier) is the unique name of the wireless network.
- >Old Password: 5 or 13 ASCII characters, the password you are using now
- >New Password: 5 or 13 ASCII characters, the password you want to use
- >Confirm Password: 5 or 13 ASCII characters, re-enter the new password
- >Channel: Specify the effective channel of the wireless network
- >Device IP: IP Address of W906.

5-2. Configure the parameters, click "Apply" button to submit the changes. And then you should reconnect the W906 wireless AP and input new password (if necessary).

Note: If you forget the password, you can hold down the reset button for 3 seconds to clear the password!

FCC Statement This device complies with Part 15 of the FCC rules.

Operation is subject to the following two conditions:

- (1) This device may not cause harmful interference, and
- (2) This device must accept any interference received, including interference that may cause undesired operation.

Note: The manufacturer is not responsible for ANY interference, for example RADIO or TV interference, caused by unauthorized modifications to this equipment. Such modifications could void the user's authority to operate the equipment.

Specifications

Compliance with	IEEE 802.11g, IEEE 802.11b, IEEE 802.3, IEEE 802.3u, IEEE 802.3x, CSMA/CA, CSMA/CD, TCP/IP, DHCP, PPPoE
Interfaces	USB Port: A-type plug/AP Mode: power only) LAN Port: Ethernet RJ45 slot x 1(Auto MDI/MDIX)
Wireless specification	Frequency: 2.4 ~ 2.4835GHz
	Transmission Rate: 11g: 6/9/12/18/24/36/48/54Mbps 11b: 1/2/5.5/11Mbps
	Channels: 14
	Anti-Radio-Interference: DS-SS (Direct Sequence Spread Spectrum)
	Data Modulation: IEEE802.11g: OFDM; IEEE802.11b: CCK,OPSK,BPSK;
Wireless medium	Medium Access Control Protocol: CSMA/CA with ACK Wireless Security: 64/128/152-WEP Wireless Transmission Gain: 20dBm (Max.) Antenna Type: 1 PIFA antenna 10Base-T/100Base-TX
LED indicator	Status LED indicator: LAN Link/Act status & system status LED indicator Power LED indicator: PWR (Power LED indicator)
Dimensions (L x W x H)	85.3mm x 28.8mm x 22.7mm
Temperature	Operating temperature: 0°C to 40°C Storage temperature: -40°C to 70°C
Humidity	Operating humidity: 10% ~ 90% RH none-condensing Storage humidity: 5% ~ 90% RH none-condensing